

Crystal L. Vanuch, Chairman
Cindy C. Shelton, Vice Chairman
Tinesha Allen
Meg Bohmke
Thomas C. Coen
L. Mark Dudenhefer
Gary F. Snellings

Frederick J. Presley
County Administrator

August 17, 2021

Bagby, Foroughi, Goodpasture, PLLC
125 Olde Greenwich Drive, Suite 115
Fredericksburg, VA 22408

SUBJECT: *Application; Tax Map Parcel No. 59-8; Zoning Administrator Determination*

Dear Mr. Foroughi:

This letter is in response to your attached request for a Zoning Administrator Determination dated March 6, 2021, regarding the location of the zoning line for Tax Map Parcel 59-8.

The property located on Tax Map Parcel 59-8 is located within both the A-1, Agricultural and A-2, Rural Residential zoning districts and is subject to the uses in accordance with the Stafford County Zoning Ordinance, Section 28-35, Zoning District Uses and Standards specifically for each zoning district.

This office is unable to determine the exact location of the zoning district line. However, a map is provided showing the approximate location according to our Zoning District Map. The light green area is the A-1, Agricultural zone, and the dark green area is the A-2, Rural Residential zone.

This determination may be appealed to the Board of Zoning Appeals within thirty (30) days from receipt of this letter, in accordance with Sec. 15.2-2311 of the Code of Virginia, or this decision shall be final and un-appealable. You may obtain the BZA appeal application at <https://staffordcountyva.gov/DocumentCenter/View/3700/Appeal-Application>. The fee for such an application is \$1,952.25.

Sincerely,

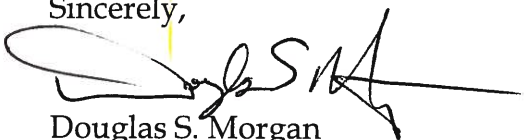

Douglas S. Morgan
Zoning Administrator

DSM:jas
attachment



Tax Map Parcel No. 59-8

Zoning Map

Produced by the Stafford County Department of Planning and Zoning
540-658-8668 | P.O. Box 339 Stafford, VA 22555

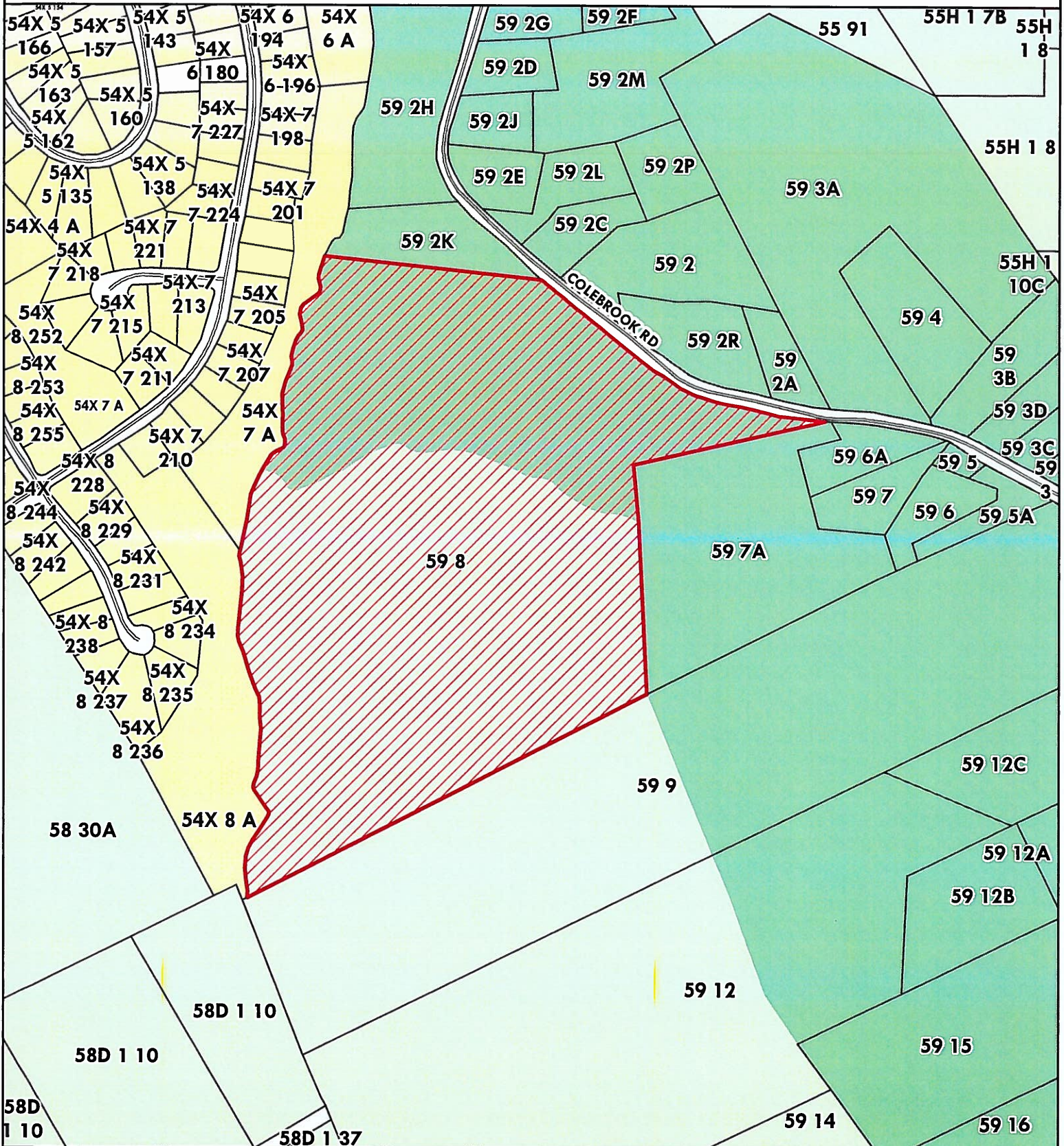

0 225 450 900 Feet

Produced: 8/17/2021

Data layers are compiled from various sources and are not to be construed or used as a "legal description." Data layers are believed to be accurate, but accuracy is not guaranteed.

